

WASHINGTON TWP., LE SUEUR CO.

6 Miles East and 5 Miles North of Mankato.

1902

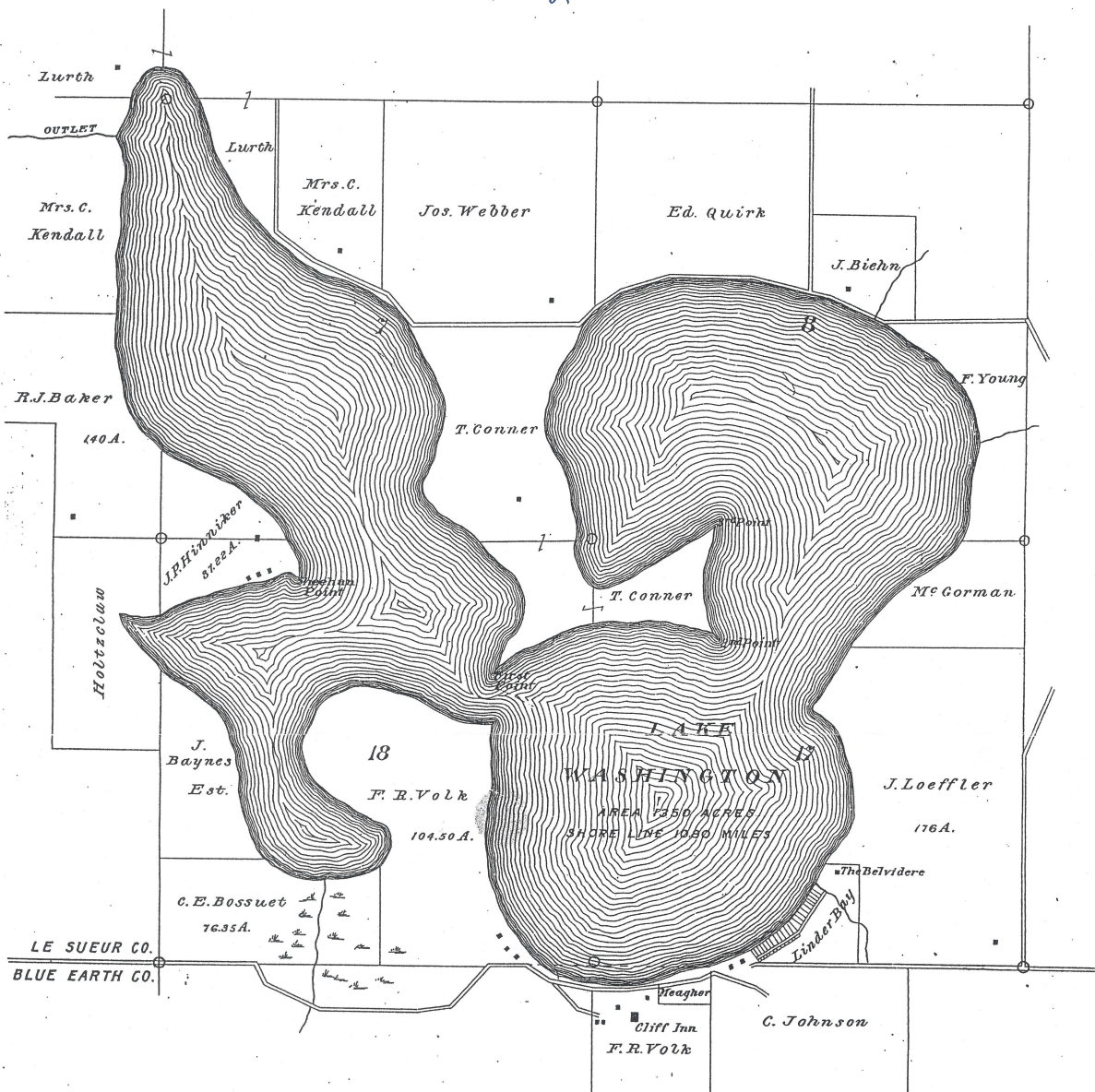

This lake is surrounded by wooded hills and fine views. In places very deep and well stocked with fish. It is reached by a twelve mile drive or by train to Madison Lake and a three mile drive. Linder Bay has been platted into lots and a dozen Mankato men have cottages there.

A proposed Trolley Line will bring this lake into direct connection with Mankato and towns east.